

WWA120 WCS 8kg Active

W1 front-loader washing machine:

A -10 %* | 8 kg | 1400 rpm | CapDosing | Honeycomb drum | AddLoad



- Tested for 20 years of perfect laundry care*
- Save even more energy with A -10 %**
- Exclusive CapDosing range for different fabrics and stains***
- Our honeycomb drum ensures that laundry stays in perfect condition
- Add or remove individual items during the wash cycle with AddLoad

* During the development phase of the W1 washing machine series, Miele tested models and core components in 5000 wash loads (= 5 wash loads per week for 50 weeks per year) in various programmes. More: miele.com/20years

** 10 % more economical than the threshold value (52) for energy efficiency class A

*** Patent EP 2 365 120



EAN: 4002516867302 / Material number: 12721160 / Old Material Number: 11WA1201GB

Construction type

Suitable for stacking
Side-by-side
Slot-in

•
•
•

Door hinge

right

Model

Product brand
Front-loader

W1 White Edition

•

Spinning

Max. spin speed
Rinse hold
Without spin function

1400

•

•

Design

Appliance colour
Control panel colour
Door design

Lotus white

Lotus white

Obsidian black with white ring

Rotary selector colour

Lotus White

Control panel version

5° inclined

Control type

Rotary control

Display

EasyControl yellow

Cleaning performance

CapDosing portioned dispensing

•

Gentle laundry care

Honeycomb drum
Load in kg

•

8.0

User convenience

Delay start up to 24 hours
Time left display
AutoClean detergent drawer
AddLoad

•

•

•

•

Efficiency and sustainability

Energy efficiency class (A–G)

A

More economical than the threshold value (52) for energy efficiency class A

10%

Weighted energy consumption per 100 operating cycles for the wash cycle in kWh

43

Weighted water consumption per cycle in l

48

Spin efficiency class (A–G)

B

Acoustic airborne noise emission class (spin cycle; A–D)

A

Sound emissions during spin cycle in dB(A) re 1 pW

72

Duration of the "ECO 40–60" programme at nominal capacity

219

Power rating in off mode in W

0.30

Low temperature wash "Cold" and "20 °C"

•

Automatic load control

•

Flow meter

•

Foam sensing

•

ProfiEco motor

•

WWA120 WCS 8kg Active

W1 front-loader washing machine:

A -10 %* | 8 kg | 1400 rpm | CapDosing | Honeycomb drum | AddLoad



EAN: 4002516867302 / Material number: 12721160 / Old Material Number: 11WA1201GB

Wash programmes

Cottons (coloureds)	•
Cottons with pre-wash	•
Minimum iron	•
Delicates	•
Woollens (hand-washable)	•
Express 20	•
Dark garments / Denim	•
Outerwear	•
Proofing	•
Separate rinse/Starch	•
Drain / Spin	•
ECO 40-60	•

Washing extras

Short	•
Soak	•
Water plus	•
Additional rinse cycle	•

Safety

Water protection system	Watercontrol-System
Safety lock	•
PIN-Code	•
Optical interface	•

Technical data

Dimensions in mm (width)	596
Dimensions in mm (height)	850
Dimensions in mm (depth)	643
Appliance depth in mm with opened door	1054
Appliance depth excluding door (for building-under) in mm	600
Weight in kg	80
Total rated load in kW	2.10-2.40
Voltage in V	220-240
Fuse rating in A	13
Frequency in Hz	50
Length of supply lead in m	2

WWA120 WCS 8kg Active

W1 front-loader washing machine:

A -10 %* | 8 kg | 1400 rpm | CapDosing | Honeycomb drum | AddLoad

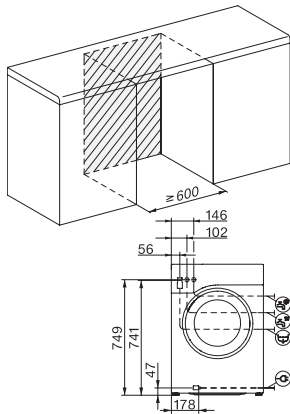

W1 drawing, facia 5 degree, measures in mm

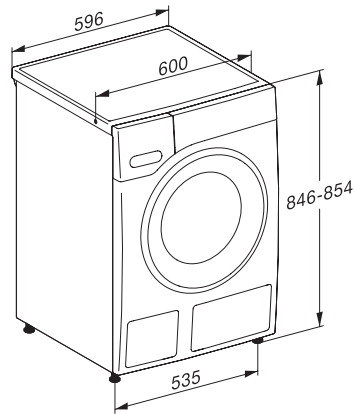

W1 drawing, facia 5 degree, measures in mm

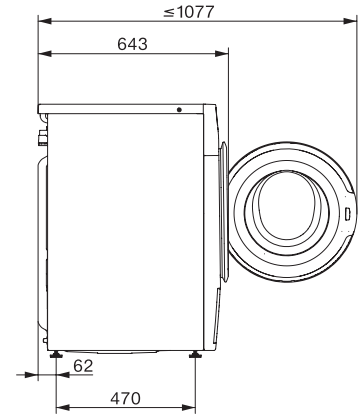

W1 drawing, facia 5 degree, measures in mm

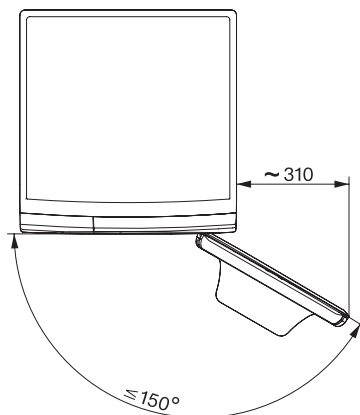

W1 drawing, facia 5 degree, measures in mm