



## SPECIFICATIONS

<b>CPU</b>	Intel® Core™ i7-13700 Intel® Core™ i5-13400 Intel® Core™ i3-13100
<b>OS</b>	Windows 11 Home Windows 11 Pro - MSI recommends Windows 11 Pro for business
<b>Chipset</b>	Intel® H610
<b>Storage</b>	1x M.2 SSD (auto switch) 1x 2.5" HDD / SSD
<b>Graphics</b>	Intel® UHD Graphics
<b>Memory</b>	2x DDR4 3200MHz SO-DIMMs, up to 64GB
<b>Panel Resolution</b>	27" IPS Grade Panel LED Backlight (1920*1080 FHD) with MSI Anti-Flicker technology
<b>Touch Panel</b>	Non-touch
<b>Audio Speaker</b>	2x 3W
<b>I/O</b>	1x USB 3.2 Gen 2 Type C 1x USB 3.2 Gen 2 Type A 2x USB 3.2 Gen 1 Type A 2x USB 2.0 Type A 1x RJ45 1x HDMI™ out (2.0b) 1x DP out (1.4) 1x Mic-in 1x Line-out
<b>Audio</b>	Realtek ALC897
<b>LAN</b>	Realtek RTL8111H
<b>Wireless LAN</b>	Intel Wi-Fi 6E AX211 Intel WWi-Fi 6 AX201 Intel Wireless AC 3168 (either one)
<b>Bluetooth</b>	5.3 (for AX211) / 5.2 (for AX201) / 4.2 (for AC 3168)
<b>Webcam</b>	Built-in FHD Webcam which supports Windows Hello Removable webcam cover design
<b>Keyboard / Mouse</b>	Optional
<b>AC Adapter</b>	120W
<b>Adjustment (Tilt)</b>	-5° ~ 20°

## FEATURES



### Anti-Flicker technology

MSI Anti-Flicker technology provides a very comfortable viewing experience by reducing the amount of screen flicker.



### Less Blue Light

Effectively reduce blue light which could cause serious long-term damage to your eyes.



### Anti-Glare Display Design

An anti-glare display makes viewing the display more pleasant for users and reduces eyestrain for users.



### MSI Center

The MSI Center takes optimization to the next level with easily adjustable system modes and resources for a wide range of scenarios and needs.



### Silent PRO Colling

3 independent chambers with exclusive thermal module provide the best solution while rendering, editing and multitasking.



### TPM Support

FW TPM design secures your confidential data with encryption keys.



### Tool Less Design

Assemble and disassemble the stand without any tools needed.



### IPS Grade Panel

Instantly optimize the screen colors and brightness to ensure that you enjoy every detail at its best while creating your own on-line video.

## CONNECTIONS

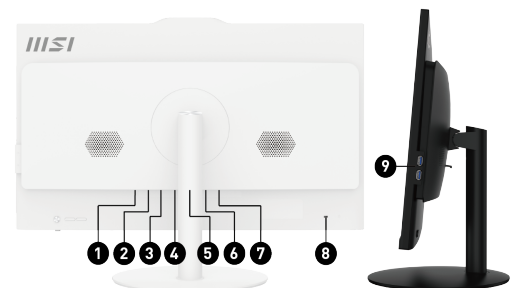

1. DC Jack
2. 1x HDMI™ out (2.0b)
3. 1x DP out (1.4)
4. 1x RJ45
5. 1x USB 3.2 Gen 2 Type-A/ 1x USB 6.3.2 Gen 2 Type-C
6. 2x USB 3.2 Gen 1 Type A
7. 1x Mic-in/ 1x Line-out
8. 1x Kensington lock
9. 2x USB 2.0 Type-A



ALL-IN-ONE PCS

## PRO AP272 13M

BE YOUR WINDOW TO THE WORLD



### MANAGEMENT UTILITY

MSI Center: Hardware Monitoring, Free Up Memory, Clean Up Disk, MSI Recovery, F3 Recovery, Devices Speed Up, Smart Priority, Smart Image Finder, Noise Cancellation, Live Update, Microsoft App Update, System Info, Troubleshooting, Contact Us, MSI Forum & Channel MSI Display Kit: Split Window, Display Setting (Orientation, resolution, refresh rate, size of text and app), Display Color Setting (Customizable Link App: Eye Saver Mode, Personal setting, Standard, Gaming, FPS, RTS/RPG, Cinema), Connect to wireless display, On-screen keyboard, Mouse Sensitivity, Power setting, Magnifier (Zoom in / Zoom out), Project way setting (internal/ Clone/ Extend/ External)

### SECURITY UTILITY & DEVICE

MSI Center: System Diagnosis, Tile (Find My Device) Tobii Aware: - Security and Privacy: Privacy Screen/ Auto Lock/ Peeker Detection - Dim Screen: Energy saving - Windows Snap - TPM 2.0 Support

### Net Weight

4.63 kg (10.21lbs)

### Gross Weight

8 kg (17.64 lbs)

### Certificates

FCC, CB/CE, UL & CUL, VCCI, RCM

### Note

Support VESA wall mount kit with specific screws, please contact with service center.