

3. Audio Quality and 7.1 Virtual Surround Playback Settings

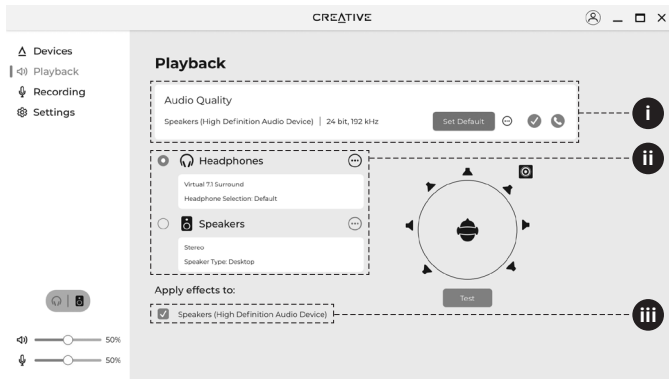

- i. Playback endpoints shown will vary depending on your PC build. To enhance audio quality and activate virtual 7.1 surround, click on the **[Set Default]** button to set the settings as system default.
- ii. Click on **[Headphones]** to set it as your preferred audio processing output.
- iii. Click on the checkbox to apply Sound Blaster's effects on your selected endpoint. Click on the checkbox again to reverse the effects applied.

Important: Ensure "Surround" in the Acoustic Engine module is turned on to enjoy virtual 7.1 surround on headphones

CREATIVE®



GETTING STARTED WITH SOUND BLASTER STUDIO ESSENTIAL

Multi-language leaflet is available for download on
creative.com/support/sbblaze2

1. Getting Started

The Creative app is a unified application offering an array of modules, settings, and more to further enhance your device's performance.

Get more from your Sound Blaster Blaze V2 by activating the Sound Blaster Studio Essential on Windows for a greater audio immersion in 4 simple steps.

1. Plug the Sound Blaster Blaze V2 headset into an available AUX-in port on your Windows PC
2. Visit creative.com/support/sbblazev2 and click on the **Download** button under **ALL DOWNLOADS** section for the Creative app. Follow the on-screen instructions to install and set up the application
3. Once the Creative app is installed, launch the application. New users may start by creating a Creative account. Existing users may continue by signing in with their Creative account
4. Follow the on-screen instructions to register the headset. Upon registration, a dialog prompt will appear for software activation



Register your Sound Blaster Blaze V2 headset
via the serial number provided below

Serial Number	

For more information on activating the Sound Blaster Studio Essential, please visit creative.com/support/sbblazev2.

2. Modules

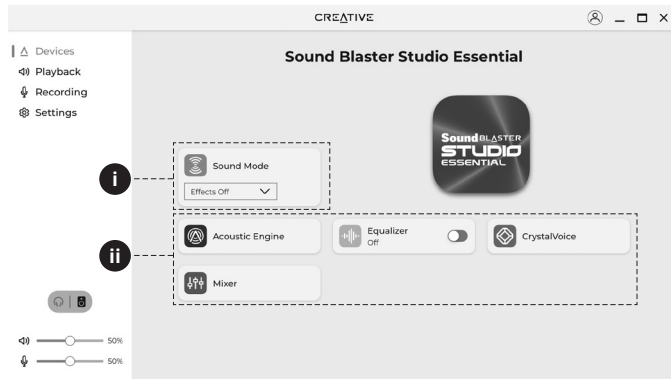

- i. Presets such as Gaming, Movies, and Music are available under the Sound Mode module to enhance your playback experience. Click on the dropdown button to select and apply a preferred preset. You may also further personalize your playback experience by customizing and saving them as new profiles for future use.
- ii. Additional customizations, audio tunings, and EQ adjustments are available by clicking the available modules. Access features and settings such as Smart Volume, Dialog Plus, microphone adjustments, and more for unique listening experiences.